

Matthew Clark 100 acres  
Charlton Kent

NEW BRUNSWICK.

S. L. Tilley

Victoria, by the Grace of God, of the United Kingdom of Great Britain and Ireland,  
QUEEN, Defender of the Faith, &c. To all to whom these Presents shall come. Greeting:  
KNOW YE. That We, of Our special grace, certain knowledge, and mere motion, have given and  
granted, and We do, by these Presents, for Us, Our Heirs and Successors, give and grant unto

Matthew Clark his heirs and assigns  
a tract of land situate in the parish of Charlton  
in the County of Kent in Our Province of New  
Brunswick and bounded as follows to wit  
Beginning at the point of intersection of the  
southerly bank or shore of the Kouchibouguac  
river by the easterly line of the Intercolonial  
Railway track and reservation thence south  
three degrees west fifty Chains thence south  
eighty seven degrees east twenty Chains thence  
north three degrees east fifty two Chains and  
fifty links to a fir tree standing in the southerly  
bank or shore of the abovesaid river  
and thence following the various courses  
thence up streams in a westerly direction  
to that place of beginning continuing one  
hundred acres more or less in the southerly  
bank or shore of Kouchibouguac river west  
of the Intercolonial Railway Reservation

*[Handwritten flourish]*

and also particularly described and marked on the Plot or Plan of Survey hereunto annexed; together with all profits, commodities, hereditaments, and appurtenances whatsoever thereunto belonging, or in any wise appertaining; except and reserved, nevertheless, out of this present Grant, to Us, Our Heirs, and Successors, all Coals, and also all Gold and Silver, and other Mines and Minerals: TO HAVE AND TO HOLD the said tract of Land, and all and singular the Premises hereby granted, with their appurtenances, (except before excepted), unto the said

Matthew Clark his heirs and assigns FOR EVER.  
PROVIDED always, and this present Grant is upon condition, that the same Grant be registered in the Secretary's Office of Our said Province of New Brunswick, to which Registry shall be attached a duplicate of the Plan, hereunto annexed.

GIVEN under the Great Seal of Our Province of New Brunswick.

WITNESS

WITNESS, Our trusty and well beloved, *His Honor the Honourable*  
*Samuel Leonard Kelly Esq. Lieutenant Governor*  
of Our said Province, at Fredericton, the *first* day of *May*  
in the Year of Our Lord one thousand eight hundred and *seventy seven* and in the  
*fortieth* Year of Our Reign.

*By Command of the Lieut. Governor*  
*Geo. Geo. Fraser*

No. *16.781*  
Registered the *2<sup>nd</sup>* day of

*May 1877*  
*Geo. Geo. Fraser*

*Geo. Geo. Fraser*

Parish of  
*Coventry*  
**COUNTY OF KENT**

Scale 25 Chains to an Inch.

*Ray Turner*  
SURVEYOR GENERAL

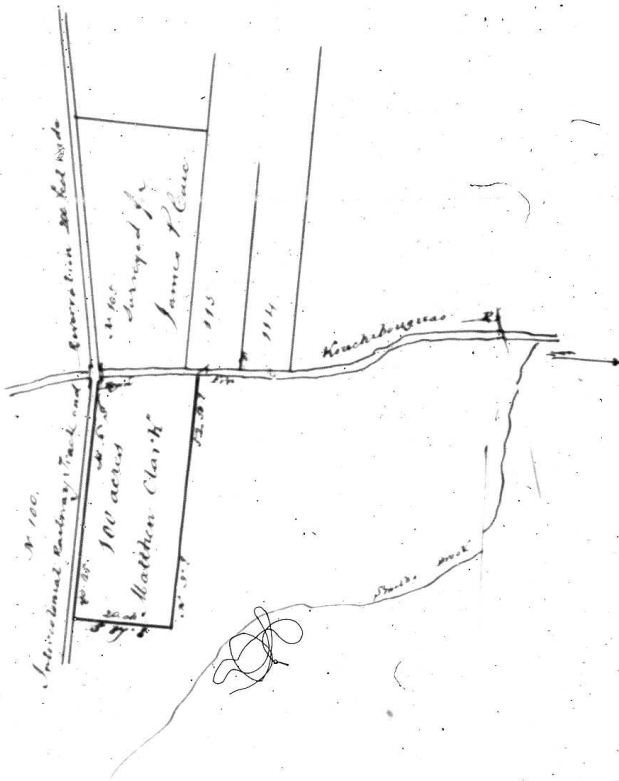

*Ray Turner*